

INSTRUCTIONS

1. Please count and make sure all pieces are present before assembly.
2. The pole pieces are delicate. To prevent damage, do not use excessive force.
3. Assemble crystal puzzle by putting the puzzle pieces together in the order shown below.
4. Piece numbers are not necessarily in the order of assembly. Some pieces do not have numbers.
5. Missing a piece? Email info@ugames.com or call (415) 503-1600 with missing piece number.

STEP	PIECE NO.		STEP	PIECE NO.		STEP	PIECE NO.
1	Right Leg	21	21	Upper Body (Back Side)	11	41	Left Arm & Leg
2		33	22		2	42	3
3		9	23		32	43	Head
4		Right Foot	24		31		
5	Left Leg	36	25	22			
6		16	26	18			
7		30	27	15			
8		Left Foot	28	17			
9	Lower Body	1	29	20			
10		R & L Leg	30	13			
11		5	31	37			
12		26	32	35			
13		10	33	19			
14	7	34	27				
15	Upper Body (Front Side)	6	35	23			
16		4	36	24			
17		12	37	28			
18		8	38	25			
19		29	36	14			
20		34	40	Right Arm + Right Hand			

HINTS

Build Buzz Lightyear's legs first and connect them to his pelvis. Build the front and back of his body starting with pieces 7, 10, and 26 (each puzzle piece has a number printed on it).

Assemble leg parts first and then attach parts #1 and 5.

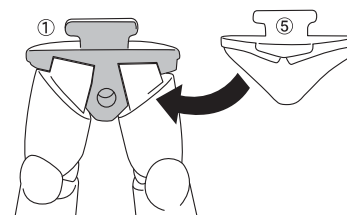

Before assembling upper body use parts # 7, 10, and 26 to connect the lower body.

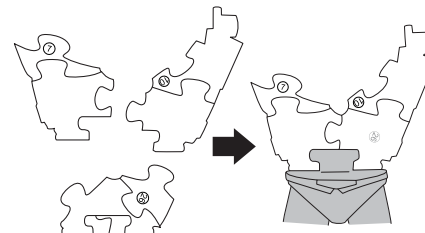

See our entire line of games and puzzles at:

